

Woodchurch High School, Carr Bridge Road, Woodchurch

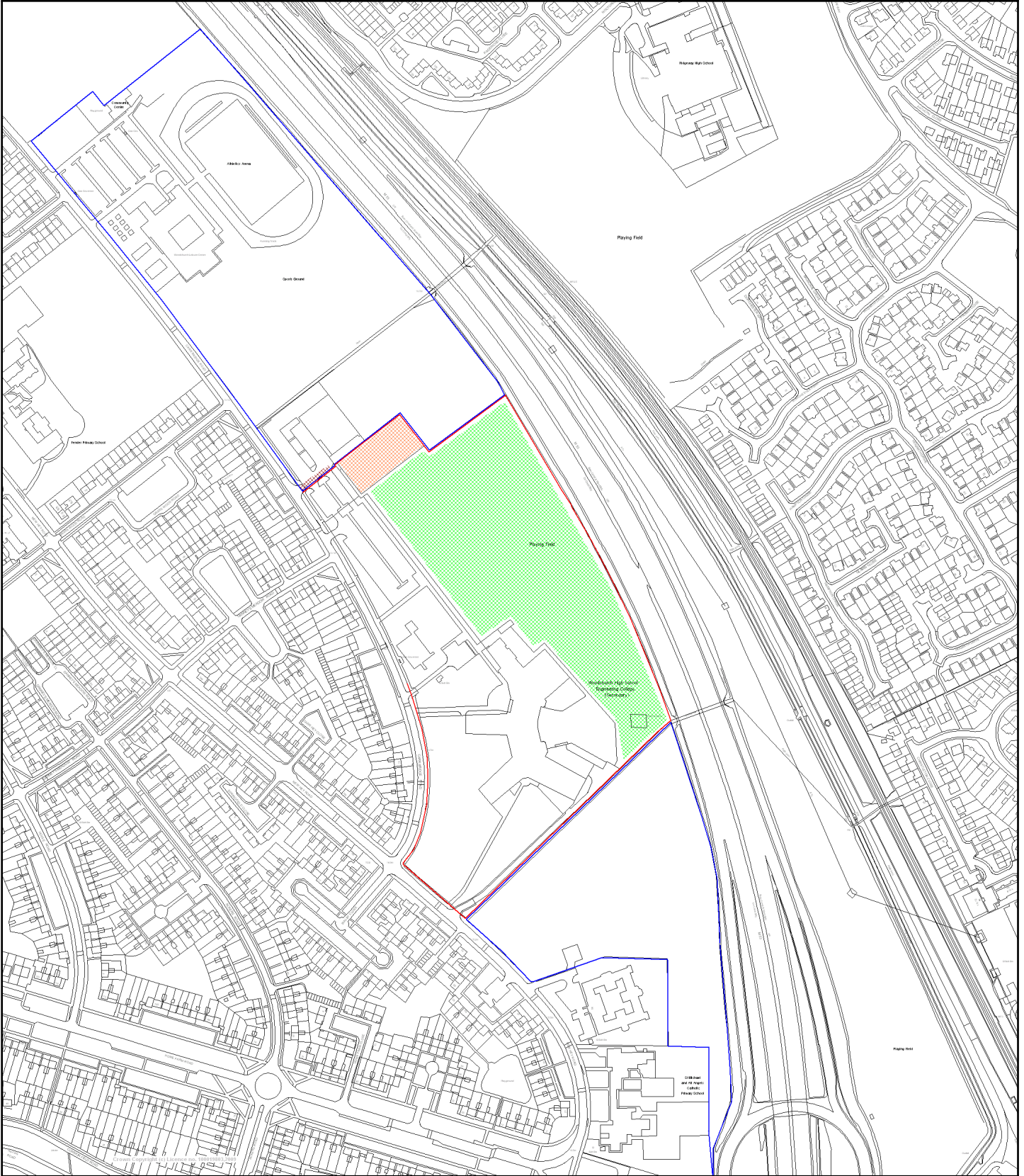

© Crown copyright and database rights 2011
Ordnance Survey 100019803

Scale 1/5000 Date 5/10/2011
Centre = 328550 E 387078 N

Asset Management Section, Dept. of Law, HR and Asset Management, Cheshire Lines Building, Canning Street, Birkenhead, CH41 1ND
Tel: 0151 666 3882, Fax: 0151 606 2090

